

ROGY Docking

Quick User Guide

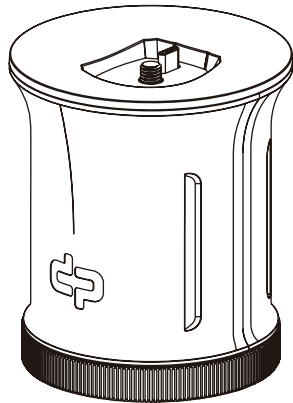

OVERVIEW

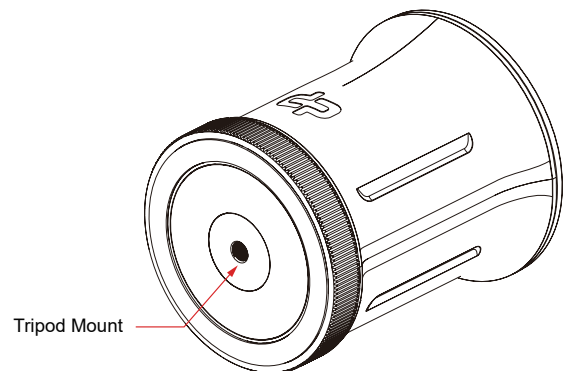
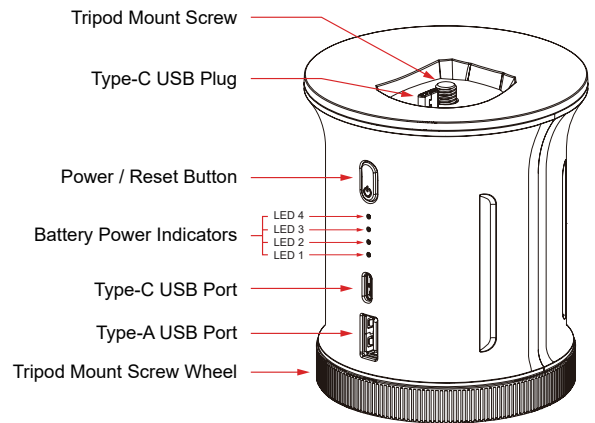

OPERATION 1

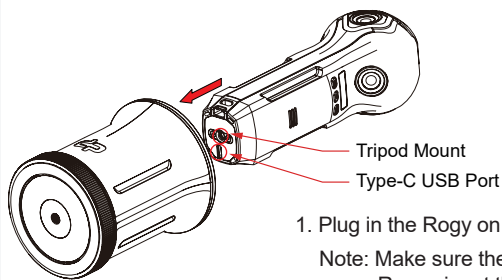

1. Plug in the Rogy on the Docking.

Note: Make sure the tripod mount of Rogy aim at the tripod mount screw of Docking and the Type-C USB Port has connect with the Type-C USB plug of Docking.

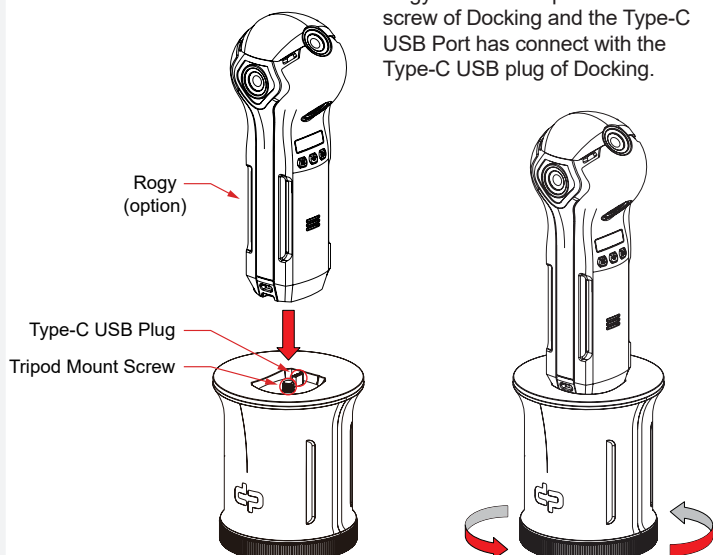

2. Push down the Rogy on the Docking then turn the Tripod Mount Screw Wheel clockwise and tight it.

OPERATION 2

3. Plug the Type-C connector of the USB cable in the Type-C USB Port of Docking.
4. Plug the Type-A connector of the USB to RJ-45 adaptor in the Type-A Plug of Docking.

Note: 1. The Docking can be used alone without to connect the USB cable and the RJ-45 adaptor as a power bank with the Rogy.

2. The type-A USB port of Docking also support the UVC mode. Connect the other Type-A plug of USB cable to a computer which support the UVC driver then you can use the Rogy as a web camera. (Rogay still support the UVC function without to mount the Docking. It can support the same UVC mode via the type-c USB cable connect Rogy to a USB port of PC directly.)

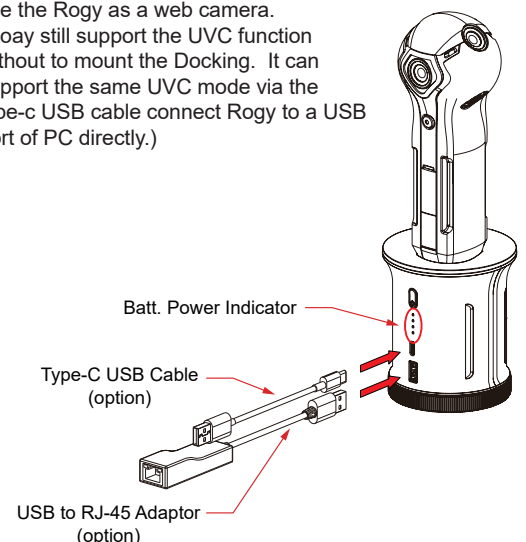

OPERATION 3

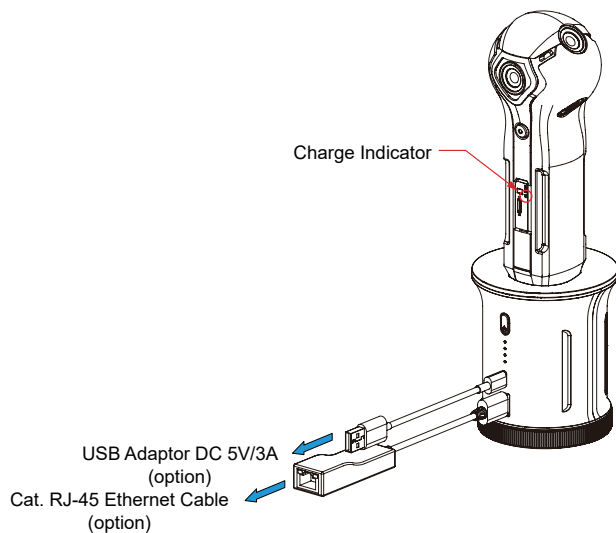

5. Plug the Type-A connector of the USB cable to the USB port of the DC 5V / 3A adaptor.

6. Insert a Ethernet Cable in the RJ-45 port of the USB to RJ-45 adaptor.

Note: The Docking will power on automatic when the Rogy plug in the Docking and the USB port of Rogy has connected. The Docking is charging the Rogy and the charge indicator of Rogy will light.

5

OPERATION 4

7. Turn the Tripod Mount Screw Wheel counterclockwise to release the Tripod Mount Screw until the Rogy separate from the Docking.

Note: Be careful and make sure you have holded the Rogy (or holded Rogy and Docking together) before release it to avoid drop down the Rogy when the tripod screw separated.

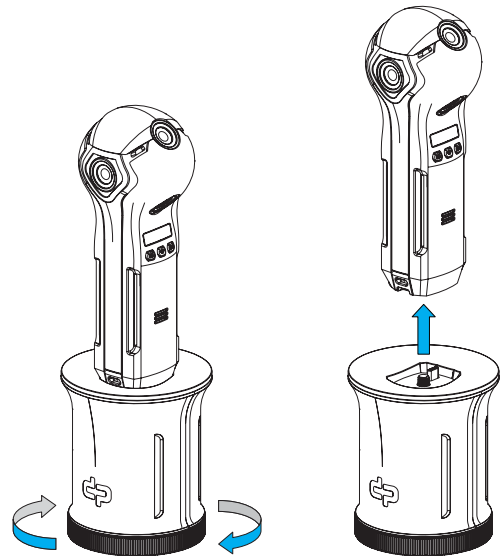

6

TECHNICAL NOTES

Charging	Battery Level	LED 1	LED 2	LED 3	LED 4
	0-25%	Blinking	Off	Off	Off
	25-50%	On	Blinking	Off	Off
	50-75%	On	On	Blinking	Off
	75-99%	On	On	On	Blinking
	Fully Charged	On	On	On	On
Discharging	Battery Level	LED 1	LED 2	LED 3	LED 4
	Undervoltage	Off	Off	Off	Off
	1-5%	Blinking	Off	Off	Off
	5-25%	On	Off	Off	Off
	25-50%	On	On	Off	Off
	50-75%	On	On	On	Off
	75-100%	On	On	On	On

Charge mode: LEDs will keep on.

Discharge mode: LEDs will off after 5 seconds. Press the Power / Reset key to show the battery level. When LED1 blinking mean the battery is low power under 5% and need to recharge.

Specifications

Model: Battery Docking Station

Battery Type: Li-ion rechargeable battery

Cell Capacity: 10000 mAh

Input: DC 5V / 3A

Output: DC 5V / 3A (max.)

Charging Time: Approx. 4 ~ 5 hours^{*1, *2}

^{*1} With the certified DC 5V / 3A adaptor and the USB cable which sold with Rogy.

^{*2} If charging the Docking and use the Rogy at the same time. Since the top priority of the battery power will supply the Rogy and use the remain power to charge the Docking. Therefore the charging time shall be longer.

Operating Temperature: 0° C ~ 45° C (charge)
-20° C ~ 60° C (discharge)

Storage Temperature: -20° C ~ 45° C

Storage Humidity: 65% ± 20% RH

Dimension: ø86 (up) x ø78 (down) x 99 (H) mm

Weight: 383.7 g

7

WARRANTY

Thank you for your interest in our products and services. This warranty is only applicable to Docking products purchased and sold this time. This warranty covers any missing parts or quality under normal use during the warranty period, and provides the body (excluding accessories and consumables) with one year warranty service. The warranty period is calculated from the date of purchase and shipment. During the warranty period, if the product fails under normal use, the company provides free replacement and repair services.

However, if the following conditions are not covered by the product warranty, the customer must bear the repair costs.

- Any natural damage, irresistible external force, abnormal operation, or human-made damage (such as: the main unit is exposed to liquid or moisture, the casing is broken, etc.).
- The user has to disassemble or repair the seal, sticker or nameplate.
- Any incorrect or improper installation, maintenance, repair, alteration or tampering with products other than those indicated in the instructions for use of the product will not be covered by the product warranty.
- The product is subject to wear and degradation due to natural disasters, misuse, accidents, natural use, improper weather conditions (such as lightning strike, flooding, rain, high temperature exposure, etc.) or lack of regular maintenance.
- The model and serial number of the product have been altered, defaced or removed.
- Damage or scratches to the appearance of the product.
- Any other product design flaws, flaws, and damage to materials.
- The warranty does not include any shipping costs, handling fees, or other costs not related to the product warranty.

If you have other questions related to the use and maintenance application, please call our customer service hotline or e-mail directly, and a customer service specialist will contact you.

Service Line: + 886 2 2696 1069
e-mail: info@dpsmart.com.tw
Web: <https://dpsmart.com.tw/contact/>

dp smart
達標智源

SAFETY NOTICE

Federal Communications Commission (FCC) Statement

15.105(b)

This equipment has been tested and found to comply with the limits for a Class B digital device, pursuant to part 15 of the FCC rules. These limits are designed to provide reasonable protection against harmful interference in a residential installation.



This equipment generates, uses and can radiate radio frequency energy and, if not installed and used in accordance with the instructions, may cause harmful interference to radio communications. However, there is no guarantee that interference will not occur in a particular installation. If this equipment does cause harmful interference to radio or television reception, which can be determined by turning the equipment off and on, the user is encouraged to try to correct the interference by one or more of the following measures:

- Reorient or relocate the receiving antenna.
- Increase the separation between the equipment and receiver.
- Connect the equipment into an outlet on a circuit different from that to which the receiver is connected.
- Consult the dealer or an experienced radio/TV technician for help.

15.19

This device complies with Part 15 of the FCC Rules. Operation is subject to the following two conditions:

- 1) This device may not cause harmful interference and
- 2) This device must accept any interference received, including interference that may cause undesired operation of the device.

15.21

You are cautioned that changes or modifications not expressly approved by the part responsible for compliance could void the user's authority to operate the equipment.

FCC RF Radiation Exposure Statement:

1. This Transmitter must not be co-located or operating in conjunction with any other antenna or transmitter.
2. This equipment complies with FCC RF radiation exposure limits set forth for an uncontrolled environment. This equipment should be installed and operated with a minimum distance of 20 centimeters between the radiator and your body.

FCC ID : 2AVSX-ROGYBATTERYDOCKING

SAFETY NOTICE

- Requirements in AT / BE / BG / CZ / DK / EE / FR / DE / IS / IE / IT / EL / ES / CY / LV / LI / LT / LU / HU / MT / NL / NO / PL / PT / RO / SI / SK / TR / FI / SE / CH / UK / HR. 5150MHz~5350MHz is for indoor use only.



Radio equipment specifications:

- (a) frequency band(s) in which the radio equipment operates
2412 ~ 2472 MHz / 5120 ~ 5350 MHz

- (b) maximum radio-frequency power
18.63 dBm ~ 18.75 dBm

- SAR is measured with the device at 5 mm to the body, while transmitting at the highest certified output power level in all frequency bands of the device. The maximum SAR value is 0.019 W/kg (head/body) averaged over 10 gram of tissue.
- This equipment should be installed and operated with a minimum distance of 5 cm between the radiator and your body.

Simplified DoC:

Hereby, dp smart technology declares that the radio equipment type Rogy Battery Docking is in compliance with Directive 2014/53/EU

The full text of the EU declaration of conformity is available at the following internet address: No. 287-2, Sec. 3, Chengde Rd., Datong Dist., Taipei City 103, Taiwan

BATTERY SAFETY NOTICE

Built-in Rechargeable Battery

Denger: Do not try to replace the built-in lithium ion rechargeable battery. If you use a battery type that is incompatible with the assigned model, there may be an explosion, overheating, or other risks. Do not try to disassemble or modify the built-in battery pack. If you try to disassemble or modify the battery pack, it may cause risks of an explosion or leakage of battery fluid.

When disposing of the battery, please follow all relevant local laws or regulations. Do not dispose of the battery pack as municipal waste, please dispose of the discarded battery according to the relevant instructions.

The built-in battery pack contains a small amount of harmful substances, to avoid injury:

- Except for the professional maintenance enginner assigned by the original manufacturer, the battery shall not be replaced.
- Keep the battery pack away from fire or other heat sources.
- Do not expose the battery pack to water, rain, or other corrosive liquids.
- Do not place the battery pack in an extremely high temperature environment.
- Do not pierce with nails, hit with a hammer, step on with your feet, strongly hit or throw the battery.
- Avoid short circuit of the battery pack.
- Keep the battery pack out of the reach of young children and pets.
- Do not place the battery pack in an environment with extremely low air pressure. It may cause an explosion or flammable liquid or gas leakage from the battery.

BATTERY SAFETY NOTICE

Built-in Rechargeable Battery

In order to prolong the battery life, it is recommended to charge the battery to more than 30% ~ 50% of the power every time, and recharge it at least every three months to avoid excessive battery discharge.

Warning: If the liquid of the battery gets into your eyes accidentally, do not rub your eyes and immediately rinse eyes thoroughly with water such as clean water. Seek medical attention immediately, otherwise it may cause vision damage.

Attention: • Please charge the lithium ion battery in a place where the room temperature is 5 ~ 35 °, otherwise it may cause the battery failed to charge or the charging time is too long, or may cause the battery to age.

- Please pay attention to the charging situation at any time, and keep away from flammable materials.
- When the battery charge indicator of the camera shows it is fully charged, you should stop charging immediately.
- When the charging time greatly exceeds the time specified by the lithium-ion battery but the charging has not been completed, please stop charging.